

Diffuser

Product

L-angles

Mounting attachment
to product

Z-Bar

Mounting attachment
to surface

Product handling & storage

- Clean white gloves must be used whenever handling panels.
- Store panels on a flat, dry, solid surface. Do not store on edge.
- Keep panels dry, clean and free from dust and damage.

Tools

- ▶ Drill
- ▶ Phillips bit
- ▶ Pop rivets
- ▶ Level
- ▶ Laser level (recommended)
- ▶ Hook-n-loop strips



Scan for technical
drawings

[conwed.com/
details-diffusers](http://conwed.com/details-diffusers)

Planning the install

- ▶ Review the materials list supplied by Conwed and any drawings. Carefully determine the starting position of the first diffuser. In many cases, standing the diffusers against walls in numbered sequence is helpful.

Installation

1. Mark a line on the wall using the top of a diffuser in the intended final installed position. Mark an additional line $\frac{3}{16}$ " below the first.
2. Mount the z-bars on the wall, so that the top of it follows the lower of the two lines. This difference in height will allow the diffuser to hang in the intended final position.
3. Identify where the L-angles on your diffusers need to be placed to hang on the z-bars in the correct orientation. Using the L-angles, mark and create pilot holes in the edges of the diffuser where needed.
 - ▶ **Note 1:** Conwed diffusers hang on z-bars from the top edge only. Use hook-n-loop strips secured to an additional l-angle on the bottom of the diffuser.
 - ▶ **Note 2:** Conwed pyramidal diffusers are NOT symmetrical. Refer to available layout plans to determine correct orientation.
4. Secure the L-angles to the diffuser using pop-rivets through the piloted holes.
5. Add a hook-n-loop strip to the lower L-angle so that it will engage with the wall. Engage the L-angles to the z-bar while pressing the strip firmly against the wall.

Step 1

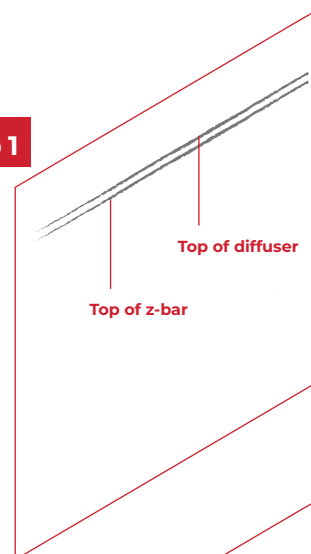

Steps 3-4

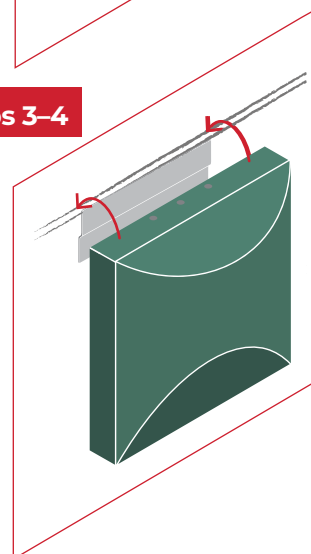

Step 5

