



Tile | Gridlock

Product

Mounting attachment
to product

Product handling & storage

- Clean white gloves must be used whenever handling panels.
- Store panels on a flat, dry, solid surface. Do not store on edge.
- Keep panels dry, clean and free from dust and damage.

Tools

Fabric wrapped tiles

- ▶ Sharp utility knife
- ▶ Escutcheon plate (recommended if applicable)
- ▶ Decorative trim (optional)
- ▶ Marker
- ▶ Spray contact adhesive
 - ▶ 3M #74 or #77 recommended

Painted tiles

- ▶ T or L Channels (if possible)
- ▶ Clean gloves
- ▶ Adjustable-depth circular saw (required)
 - ▶ with fence (recommended)
- ▶ Shop knife
- ▶ Contact spray adhesive
 - ▶ 3M #74 & #77 (recommended)
- ▶ Straight edge (T square)
- ▶ Pencil
- ▶ 120 grit sandpaper

Planning the install

- ▶ First square your gride to ensure a smooth install. Less than 1/16" diagonal variation is recommended.
- ▶ Gridlock edge ceiling tiles install like any other. Prep the sequence of tiles as you typically would, filling out the interior portion of the grid, following the tile insertion visual guide below. Once all but the exterior edge tiles are installed, proceed.

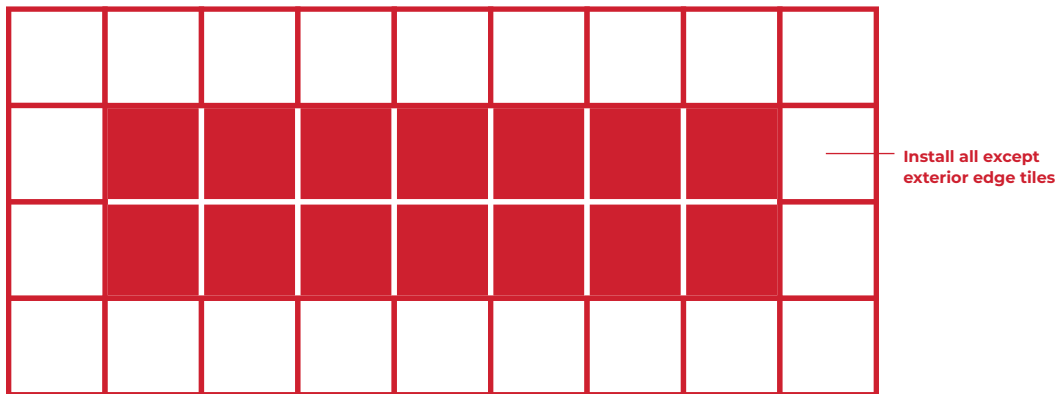

Tile insertion method

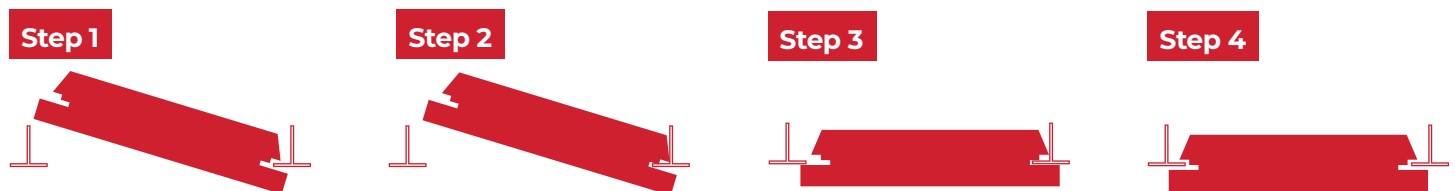

Disclaimer of liability: This technical information, in good faith, is furnished without charge or obligation and is given and accepted at recipient's sole risk. Conditions of use may vary and are beyond our control, and because of this Conwed makes no representation about, and is not responsible or liable for, the accuracy or reliability of data associated with particular uses of any product described herein.

Installing

- ▶ **Common practice is to install wall angles ½" lower than the face of the grid to hide field cut edges. If this cannot be done then follow steps below:**

Fabric wrapped tiles

- 1.** Cut the core and fabric ½" longer the intended field cut, staying as close to that line as possible, and without damaging the fabric. Use the measurements of both edges of the grid opening to determine your intended cut line.
 - ▶ **Note:** If you have a fabric that makes the panels directional, make sure the arrows on the backs of the panels are aligned and make your cuts to maintain that direction.
- 2.** Pull the fabric back from the cut edge just over ½" and not farther! Cut the core to the finished size. Note that if the fabric is pulled back too far, it will leave an objectional line on the face of the panel.
- 3.** Use a spray contact adhesive to coat both the panel core edge and the fabric.
Do not get adhesive on the face of the panel.
- 4.** If the direction of the fabric caused you to cut off an edge that rested on the grid, use the Z-Clips provided. Use 2 clips up to 30" and add one clip in the center for longer edges.
 - ▶ **Note:** The longer end of the clip is inserted into the panel.
- 5.** Install your cut panel into the grid, and repeat the process.

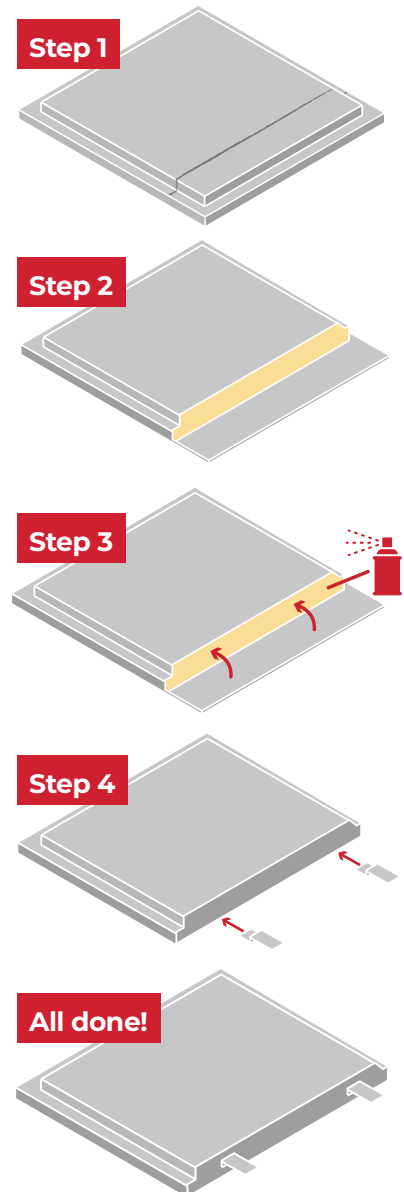

Painted tiles

1. Determine the new dimensions of the tile, marking the line on the back using a straight edge and pencil.
2. Mark another line from the first, towards the edge of the panel, offset by the thickness of the product (add $\frac{1}{2}$ " if possible). This will create excess mat
3. Cut through the whole panel on the offset mark, using a fence or straight edge to maintain a clean line
4. Set your saw blade to cut all but $\frac{1}{16}$ " of the thickness of the panel. Test cut a scrap piece from the already cut excess.
5. Cut this partial thickness through the main mark on the panel, creating the new edge of the product.
6. Using a T channel, straight edge, or sharp shop knife, carefully cut away the yellow fiberglass substrate from the finish surface of the product.

