



Specialized Products Catalog

Copyright © 2024 Conwed. All rights reserved.

This catalog, including all text, images, illustrations, graphics, photographs, product descriptions, and design elements, is protected by copyright law and international treaties. No part of this catalog may be reproduced, distributed, or transmitted in any form or by any means, including photocopying, recording, or other electronic or mechanical methods, without the prior written permission of the Copyright Owner.

All product names, trademarks, and service marks mentioned in this catalog are the property of their respective owners and are used for identification purposes only.

Date of last revision: 11.03.2023

Table of contents

Icon glossary	04	Reflective clouds	20
Specialized products	06	Reflective wall panels	24
Four acoustic functions	08	Loaded vinyl	28
Finishes	10	Low frequency tuners	32
Finding the right solution	12	Omnipane diffuser	36
Mounting	14	SelectSound	40
Diffusers	16		

Icon glossary

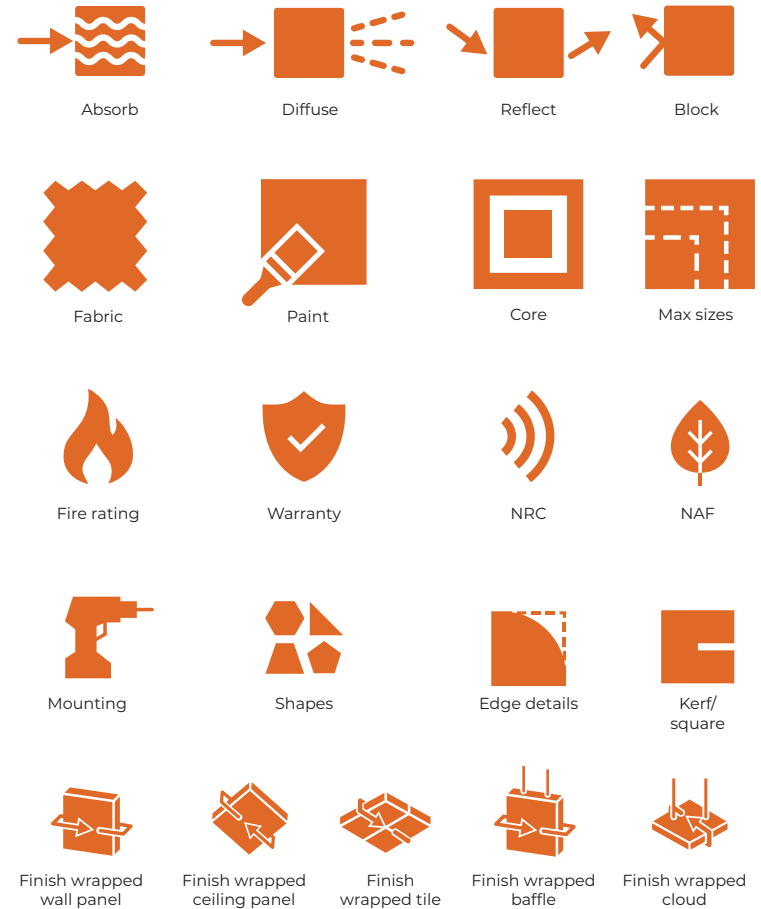

What are Specialized Products?

The primary function of an acoustic solution is to absorb unwanted noise in a space. In certain applications though, solutions need to **block, diffuse,** or **reflect** sound as well.

Our **Specialized** products are made with the same materials as our Core Products for absorbing noise but also utilize other materials in order to **block, diffuse,** and **reflect**.

These specialized acoustic properties are often used in spaces like performance centers, auditoriums, and private rooms.

Four acoustic functions



Absorb

Noise absorption is a product trapping sound waves, preventing reverberation. Sound can still pass through and around the product, but the better it absorbs, the less noise will escape it. A product's ability to absorb is measured by its Noise Reduction Coefficient (NRC).



Diffuse

Diffusion is scattering a soundwave into multiple directions, ensuring all frequencies are distributed throughout a space.



Reflect

Reflection is bouncing a soundwave back to the source, or redirecting it somewhere else; preventing soundwaves from being trapped in high spaces.



Block

Blocking noise does not quiet the room where the noise is. Rather, it prevents noise from passing through a wall or ceiling, keeping other spaces quiet.

Note → An acoustic product can have multiple of these attributes depending on the materials in it. Such as adding a vinyl blocking layer behind an already absorbing product.

Products & attributes

Core products

	Absorbs	Diffuses	Reflects	Blocks
Diffusers		✓		
Reflective clouds		✓	✓	
Reflective wall panels			✓	
Loaded vinyl	✓			✓
Low frequency tuners	✓			
Omniplane	✓	✓	✓	
SelectSound	✓			
Wall panels	✓			
Ceiling panels	✓			
Baffles	✓			
Clouds	✓			
Tiles	✓			

Finishes

Fabric

Carnegie DESIGNTEX maharam kvadrat Knoll Guilford of Maine

Paint

Any color imaginable from Sherwin Williams.

**SHERWIN
WILLIAMS®**



Finding the right solution.

Selecting the right combination of products and attributes for your space can be difficult.

CEXP is here to help you navigate all the variables and create the perfect solution with you.

419.871.9084
CEXP@conwed.com

Mounting

Reflective Wall Panels, Low Frequency Tuners, & Omniplane Diffusers



Impaling clips

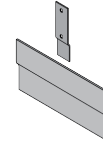

Z-clip to z-bar

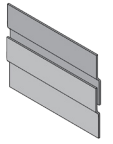

Z-bar to z-bar



Rotofast® anchor

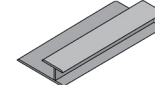

Spline

Loaded Vinyl

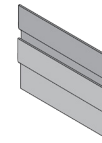

Z-bar to z-bar

Diffusers

Flange

Flanged diffusers mounting using grid.

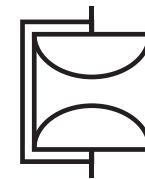

No flange

No flange diffusers mounting using L-angles.



Reflective Clouds

Depending on the size of the reflector, a different number of attachment points for heavy cables or wires will be on the product. See the full document at conwed.com/installguide-reflectivecloud

Diffusers

Diffusers are designed for performance areas, auditoriums, and other facilities requiring enhanced audio, by scattering sound frequencies in several directions.



Barrel Diffuser

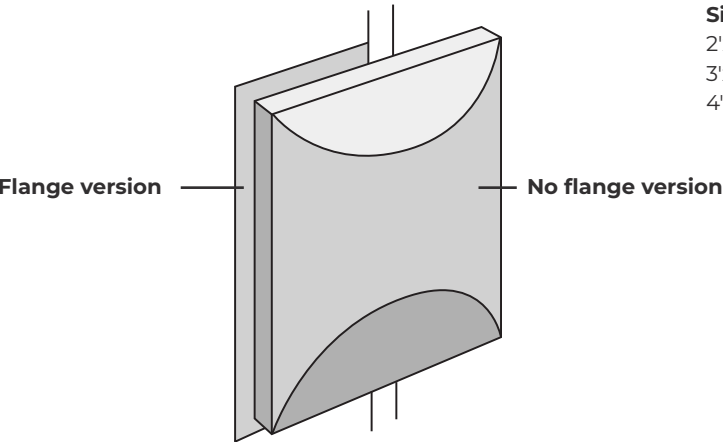

Sizes*
 2'x2', 2'x4', 3'x3',
 3'x4', 3'x6', 4'x4',
 4'x6', 4'x8'

Pyramidal Diffuser

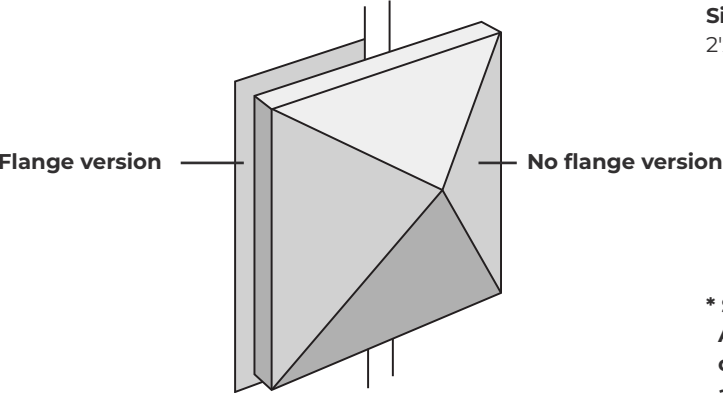

Sizes*
 2'x2', 2'x4', 4'x4'

*** Sizes are nominal. Additional & custom sizes available by request.**

Finish wrapped on all sides



Mounting

No-flange Diffusers mounted using L-angles.

Flanged Diffusers mounted using grid.

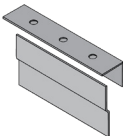

L-angles

Materials

Both Barrel & Pyramidal Diffusers can be made from thermoform or gel coat.

Thermoform
 Copolymer formed with heat into the diffuser shape/size using a mold.

Gel Coat
 Fiberglass and resin mixture is sprayed into a mold to create the diffuser shape/size.

Fabrics brands

See our **Finish Guide** for more inspiration.

Since Diffusers have such unique shapes, only certain fabric lines are compatible with them.

Carnegie
 Alex
 Elite

DESIGNTEX
 Gamut
 Rocket

maharam
 Manner
 Medium
 Messenger
 Mode

Guilford of Maine
 Anchorage
 2100

Knoll
 Beacon
 Circuit

Paint

Any color imaginable from Sherwin Williams.

SHERWIN WILLIAMS®

NRC

	Gel coat		Thermoform			
	Barrel L-angle mounted	Barrel Lay-in grid mounted	Barrel L-angle mounted	Barrel Lay-in grid mounted	Pyramidal L-angle mounted	Pyramidal Lay-in grid mounted
NRC →	0.10	0.10	0.10	0.10	0.10	0.10

The image shows the interior of a large, modern auditorium. The ceiling is a prominent feature, composed of a grid of dark, curved, segmented panels that resemble a stylized cloud or a series of overlapping arches. The lighting is dim, with the primary light source coming from the ceiling panels, which are illuminated from below. The walls are dark, and there are several vertical light fixtures on the right side. The floor is dark, and the rows of seats are visible, though they are mostly in shadow. The overall atmosphere is one of a sophisticated, contemporary architectural space.

Reflective Clouds

Reflective Clouds bounce sound to the hard-to-reach areas of an auditorium or theater, allowing audio engineers to make every seat in the house a sweet spot.

Flat Reflective Clouds

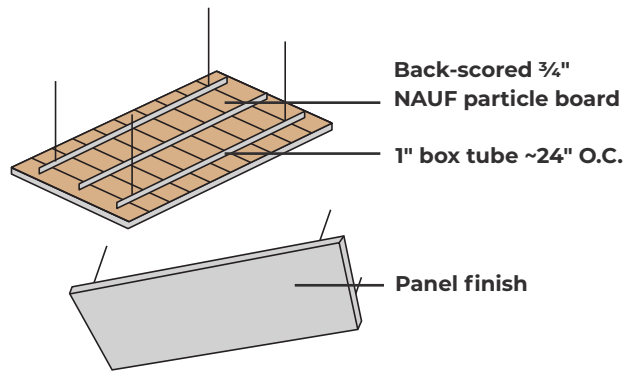

Curved Reflective Clouds

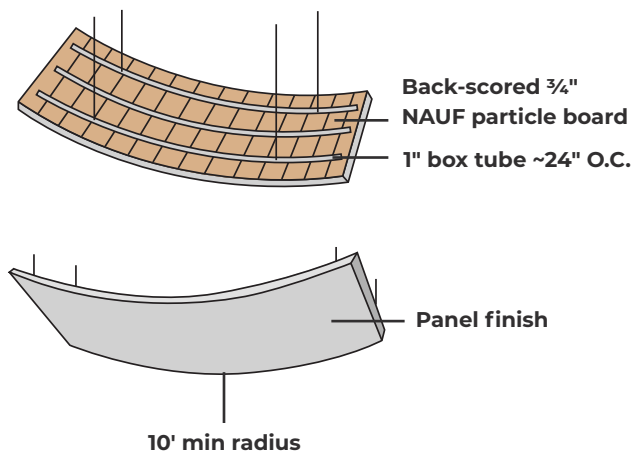

Finish
wrapped
on all sides

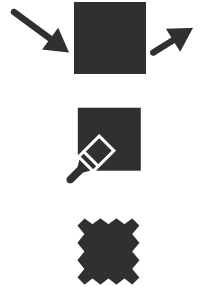

**Fabrics
brands**

See our [Finish Guide](#) for more inspiration.

Carnegie
kvadrat

DESIGNTEX
Knoll

maharam
Guilford of Maine

Paint

Any color imaginable from Sherwin Williams.

**SHERWIN
WILLIAMS®**

Wood & laminate

Contact CEXP@conwed.com for more info.

**Max size &
thickness**

Reflective Clouds are $\frac{3}{4}$ " thick and come in a max size of 4'x8'.

Mounting

Depending on the size of the reflector, a different number of attachment points for heavy cables or wires will be on the product. See the full document at conwed.com/installguide-reflectivecloud

conwed.com/datasheet-reflective-flatcloud
conwed.com/datasheet-reflective-curvedcloud

A photograph of a theater interior. The foreground is filled with rows of empty, dark-colored seats. In the background, a bright light source, possibly a stage light or a window, creates a strong glare and lens flare effect. The walls appear to be covered in dark, reflective panels. The overall atmosphere is dim and focused on the stage area.

Reflective Wall Panels

Reflective Wall Panels are designed for theaters, auditoriums, and other listening environments that require a fine balance and direction of sound; not just absorption.

Reflective Wall Panels

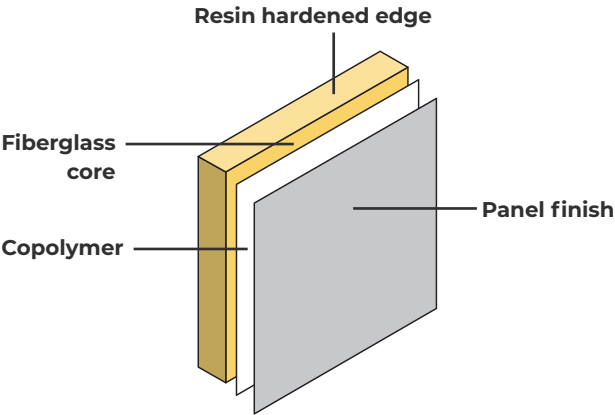

Core construction
 Dimensionally-stable 6-7 PCF fiberglass board for acoustic performance. Surface completely adhered with 1/16" solid sheet of copolymer for an acoustically-reflective and high impact-resistant finish.

Finish
 wrapped on all sides



Mounting

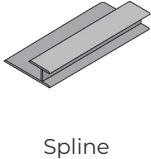
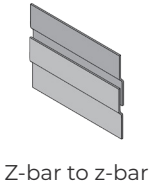
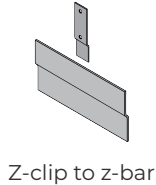

Fabrics brands

Carnegie
 kvadrat

DESIGNTEX
 Knoll

maharam
 Guilford of Maine

See our [Finish Guide](#) for more inspiration.

Paint

Any color imaginable from Sherwin Williams.



NRC average & max sizes

- NAF core
- Standard core

NRC ↓	Thickness	4'x10'		4'x12'		5'x10'	
0.20	1 1/16"		◦	•		•	
—	1 9/16"	•					
—	2 1/16"		◦	•		•	



Loaded Vinyl

Loaded Vinyl Panels are designed to block sound from passing through walls while absorbing the ambient noise within a room. Often used for speech privacy in offices, and patient consultation areas, as well as being a general sound barrier for foot traffic or industrial noise.

Loaded Vinyl Wall Panel

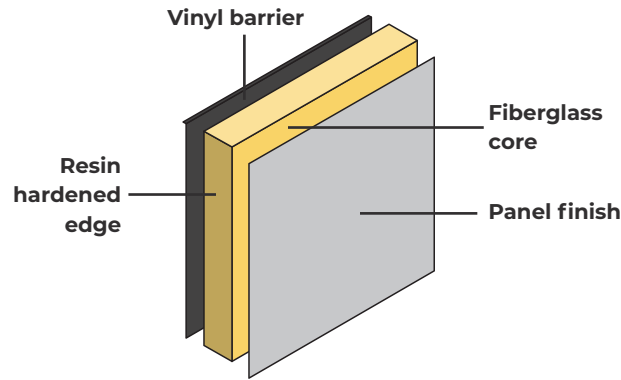

Loaded Vinyl Ceiling Panel

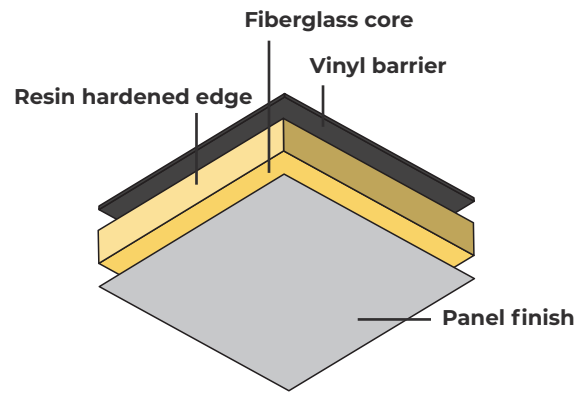

Finish wrapped on all sides



Mounting

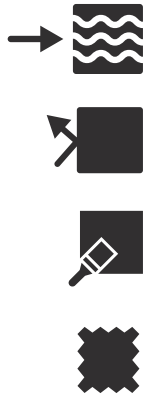
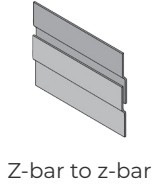

Fabrics brands

See our [Finish Guide](#) for more inspiration.

Carnegie
kvadrat

DESIGNTEX
Knoll

maharam
Guilford of Maine

Paint

Any color imaginable from Sherwin Williams.



Thicknesses & max sizes

- NAF core
- Standard core

Thickness	4' width		8' length		6' sqft	
1 1/8"	•	◦	•	◦	•	◦
1 5/8"	•		•		•	
2 1/8"	•	◦	•	◦	•	◦

Low Frequency Tuner

For when your space requires fine-tuned noise absorption, these panels target lower frequencies while maintaining some mid to high frequencies. Perfect for preventing bass traps and excessively thick panels.

We're right here!

Low Frequency Tuner Wall Panel

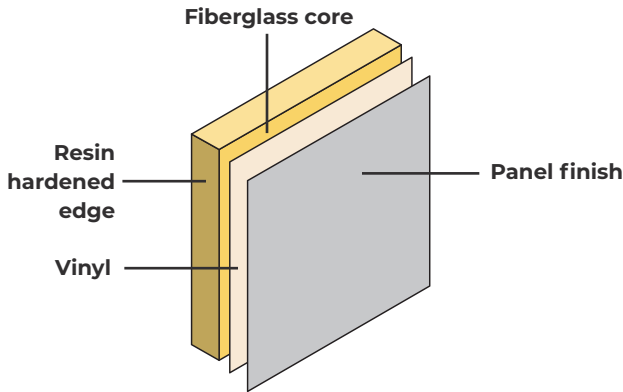

Low Frequency Tuner Ceiling Panel

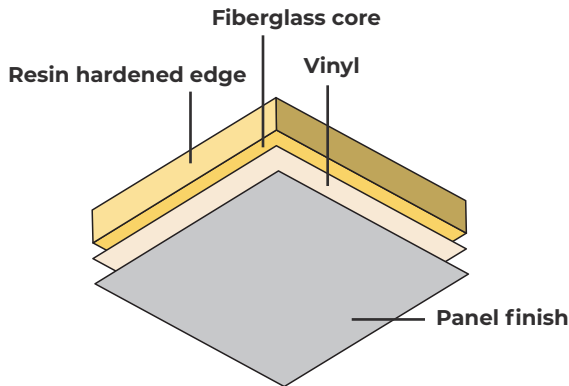

Finish wrapped on all sides



Mounting

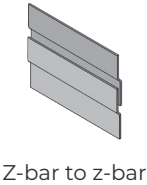
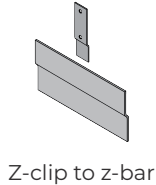

Impaling clips

Z-clip to z-bar

Z-bar to z-bar

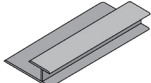

Rotofast® anchor

Spline

Fabrics brands

Carnegie
kvadrat

DESIGNTEX
Knoll

maharam
Guilford of Maine

See our [Finish Guide](#) for more inspiration.

Paint

Any color imaginable from Sherwin Williams.

**SHERWIN
WILLIAMS®**

NRC average & max sizes

NRC ↓	Thickness	4'x12'	5'x10'
0.30	2"	.	.

Omniplane Diffuser

Omniplane Diffuser Panels combine absorption and diffusion into a single product while appearing like any other fabric panel in your project.



Omniplane Diffuser Wall Panel

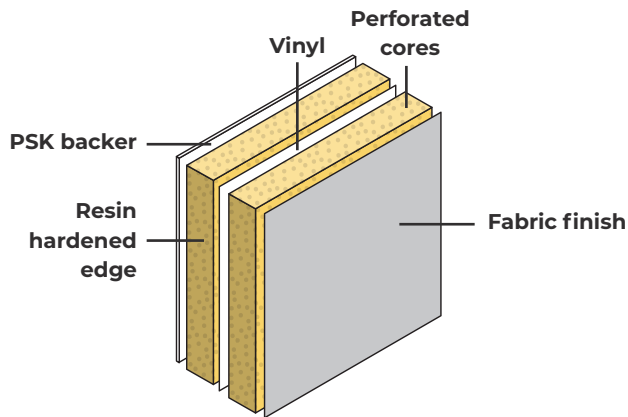

Omniplane Diffuser Ceiling Panel

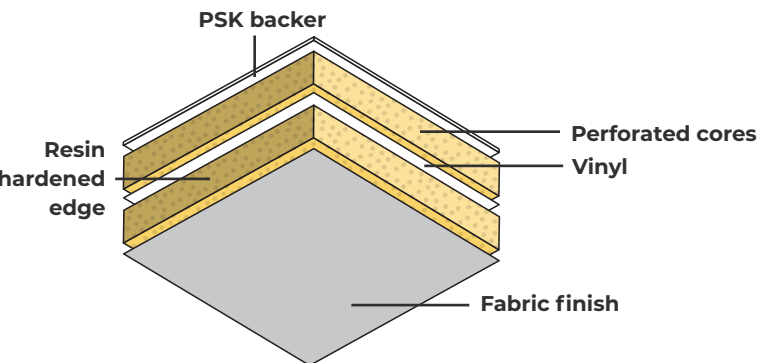

Finish wrapped on all sides



Mounting

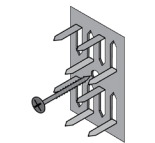

Impaling clips

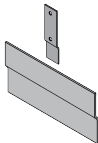

Z-clip to z-bar

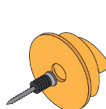

Rotofast® anchor

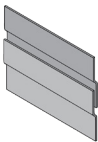

Z-bar to z-bar

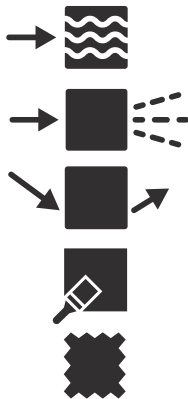

Fabrics brands

See our [Finish Guide](#) for more inspiration.

Carnegie
kvadrat

DESIGNTEX
Knoll

maharam
Guilford of Maine

Paint

Any color imaginable from Sherwin Williams.

SHERWIN
WILLIAMS®

NRC average & max sizes

2' increments only.

NRC ↓	Thickness	Ceiling		Wall	
		2'x2'	2'x4'	2'x2' min	4'x8' max
0.65	1"	✓	✓	✓	✓
1.05	2"	✓	✓	✓	✓

SelectSound

This product is engineered for high acoustic performance while being incredibly discrete. Fill large spaces or gaps between beams with this matte black, sound-absorbing fiberglass composite.

SelectSound Board

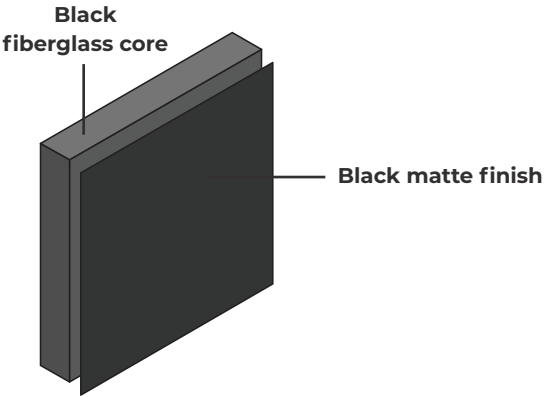

NRC average & max sizes

Only sold in whole packs.

Board Blanket	NRC ↓	Thickness	72"x70'	48"x50'	48"x96"
	0.70	1"	•		
	0.95	2"	•	•	
	0.70	1"			•
	1.00	2"			•

SelectSound Blanket

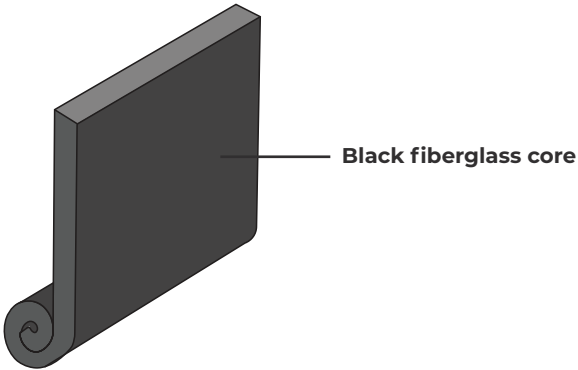

Mounting

SelectSound Board and Blanket can be installed directly to a surface by being trimmed to fit, and held in place using screws. If fitting between beams or coffer, simply trim the material to size.



*Contagious Care
Proactive Partnerships
Together is Better
Excellence and Urgency
Innovation*

