



All products made-to-order.

# Omniplane Diffuser | Wall

► Specialized

These unique panels combine absorption and diffusion into a single acoustic solution. Finished in the same textile offering as other Conwed products, Omni Plane Diffusers can blend into any acoustic solution.

## Items to specify

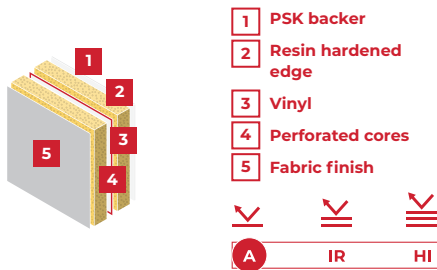

### Mounting type

Wall &amp; ceiling applications

Wall applications

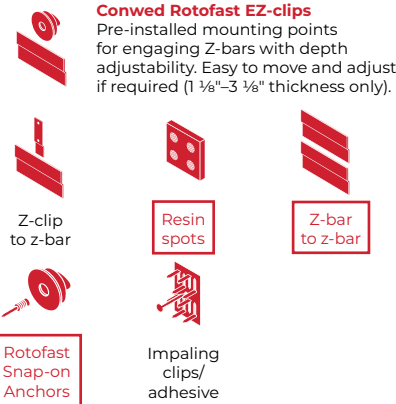

### Core thickness

1"

2"

### Hotmelt fabric adhesion

Provides superior bond strength lasting the lifetime of the product. Easily reactivated for field repairs and modification.

### Corners



### Edge profile



### Dimensions

Height: Max of 48 inches.  
Length: Max of 120 inches.

### Fabric finish

Carnegie **kvadrat** **Guilford of Maine**  
**DESIGNTEX** **Kno1** **maharam**

Click for Word specsheet  
[conwed.com/wordspecsheets/omniplanediffuser-wall](http://conwed.com/wordspecsheets/omniplanediffuser-wall)

## SECTION 098413 ► FIXED SOUND-ABSORPTIVE PANELS PART 1—GENERAL

### 1.1—SUMMARY

- A. Section includes:
  - Acoustical fabric-faced panel ceilings.
- B. Related work:
  - The following items are not included in this Section and are specified under the designated Sections:  
Section 092100 – PLASTER AND GYPSUM BOARD ASSEMBLIES for plaster and gypsum board walls and ceilings.

### 1.2—SUBMITTALS

- A. Product data:
  - Submit manufacturer's product data including certified laboratory test reports and other data required to show compliance with these specifications.
- B. Samples:
  - Submit 8 3/4 x 11 inch (for thicknesses up to 1 1/2 inches) or 11 1/2 x 11 1/2 inch (for thicknesses larger than 1 1/2 inches) samples of representative panel with factory detailed edge, and representative samples of mounting devices.

### 1.3—QUALITY ASSURANCE

- A. Pre-installation conference:
  - Conduct conference at Project site to comply with requirements in Division 01.

### 1.4—DELIVERY, STORAGE, AND HANDLING

- A. Project conditions:
  - Protect system components from excessive moisture in shipment, storage, and handling. Deliver in unopened bundles and store in a dry place with adequate air circulation. Do not deliver material to building until wet conditions such as concrete, plaster, paint, and adhesives have been completed and cured to a condition of equilibrium.

### 1.5—LIMITED WARRANTY

- A. Limited warranty:
  - Provide manufacturer's standard limited 3-year warranty against manufacturing defects in material or workmanship.



Disclaimer of liability: Technical information contained herein is furnished without charge or obligation and is given and accepted at recipient's sole risk. Conditions of use may vary and are beyond our control, and because of this Conwed makes no representation about, and is not responsible or liable for, the accuracy or reliability of data associated with particular uses of any product described herein.

## 2.1—SOUND DIFFUSERS:

### A. Basis-of-Design: Conwed Omniplane Diffuser | Wall

Formerly known as Conwed Omni Plane Diffuser Wall Panel.

1. **Construction:** Composite core construction with two layers of dimensionally stable rigid fiberglass separated by a barrier septum.
2. **Fiberglass density:** 6 – 7 pcf.
3. **Recycled content:** For fiberglass, 52 percent pre-consumer and 5 percent post-consumer recycled content.
4. **Core thickness:** 1 inch.
5. **Core thickness:** 2 inches.
6. **Width:** Max of 48 inches. Min 24 inches. 24 inch increments.
7. **Length:** Max of 96 inches. Min 24 inches. 24 inch increments.
8. **Corners:** Square.
9. **Edge profile:** Square.
10. **Edge treatment:** Resin hardened.
11. **Fabric finish:** Manufacturer, pattern and color as selected; applied directly over face and edges of panels to provide full finished edge, fully tailored corners.
12. **Fabric Adhesion:** Conwed Hotmelt is standard for bonding fabric to the substrate.
13. **Mounting type:** Impaling clips/perimeter adhesive.
14. **Mounting type:** Z-Clips to Z-Bar.
15. **Mounting type:** Conwed Rotofast™ Z-Clips.
16. **Flammability (ASTM E 84):** Panel components shall have a Class “A” rating per ASTM E 84.
17. **Resistivity to heat or cold:** R-factor of 4.16 per inch of thickness.
18. **Acoustical performance:** Values below are for panels mounted in accordance with ASTM C 423 (Type A and E400 Mounting) and vary by panel thickness and finish.
  - a. Noise reduction coefficient (NRC) for 1 inch thickness (A Mounting): 0.65.
  - b. Noise reduction coefficient (NRC) for 1 inch thickness (E400 Mounting): 0.65.
  - c. Noise reduction coefficient (NRC) for 2 inch thickness (A Mounting): 0.90.
  - d. Noise reduction coefficient (NRC) for 2 inch thickness (E400 Mounting): —.

# PART 3—EXECUTION

## 3.1—INSTALLATION:

- A. Verify wet work such as plastering and concrete is complete and dry. Verify building is enclosed and under standard occupancy conditions (60 - 85°F and not more than 70% relative humidity) prior to start of installation. Commencement of installation constitutes Installer's acceptance of surfaces and conditions.
- B. Install products in accordance with manufacturer's written instructions and in proper relationship with adjacent construction.
- C. Touch-up, repair or replace damaged units until satisfactory results are obtained.

# PROJECT ARCHITECT RESPONSIBILITY ►

This is a general specification guide, intended to be used by experienced construction professionals, in conjunction with good construction practice and professional judgment. This guide is to aid in the creation of a complete building specification that is to be fully reviewed and edited by the architect of record (specifier). Sections of this guide should be included, edited, or omitted based on the requirements of a specific project. It is the responsibility of both the specifier and the purchaser to determine if a product or system is suitable for its intended use. Neither Conwed, nor any of its subsidiary or affiliated companies, assume any responsibility for the content of this specification guide relative to actual projects and specifically disclaim any and all liability for any errors or omissions in design, detail, structural capability, attachment details, shop drawings or other construction related details, whether based upon the information provided by Conwed or otherwise.

—END OF SECTION—